

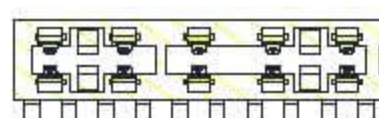

M7273

SPECIFICATION

Current rating: 6AAC, DC
 Voltage rating: 250V AC, DC
 Operating Temperature: -40°C--+120°C
 Contact Resistance: 10mΩ max.
 Insulation resistance: 1000MΩ min.
 Withstanding voltage: 2800V AC/minute
 Material: Housing: Nylon66 UL94V-0
 Terminal: Phosphor bronze, Tin-plated
 Wire range: AWG 20 to 18
 GWT: 750°C IEC-60335-1

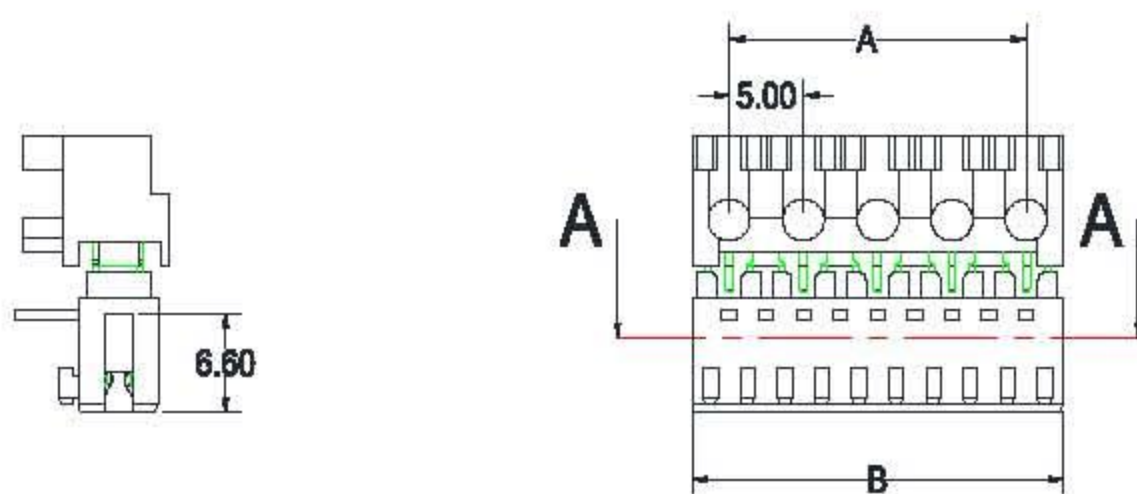
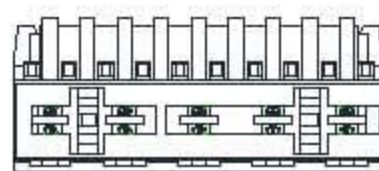
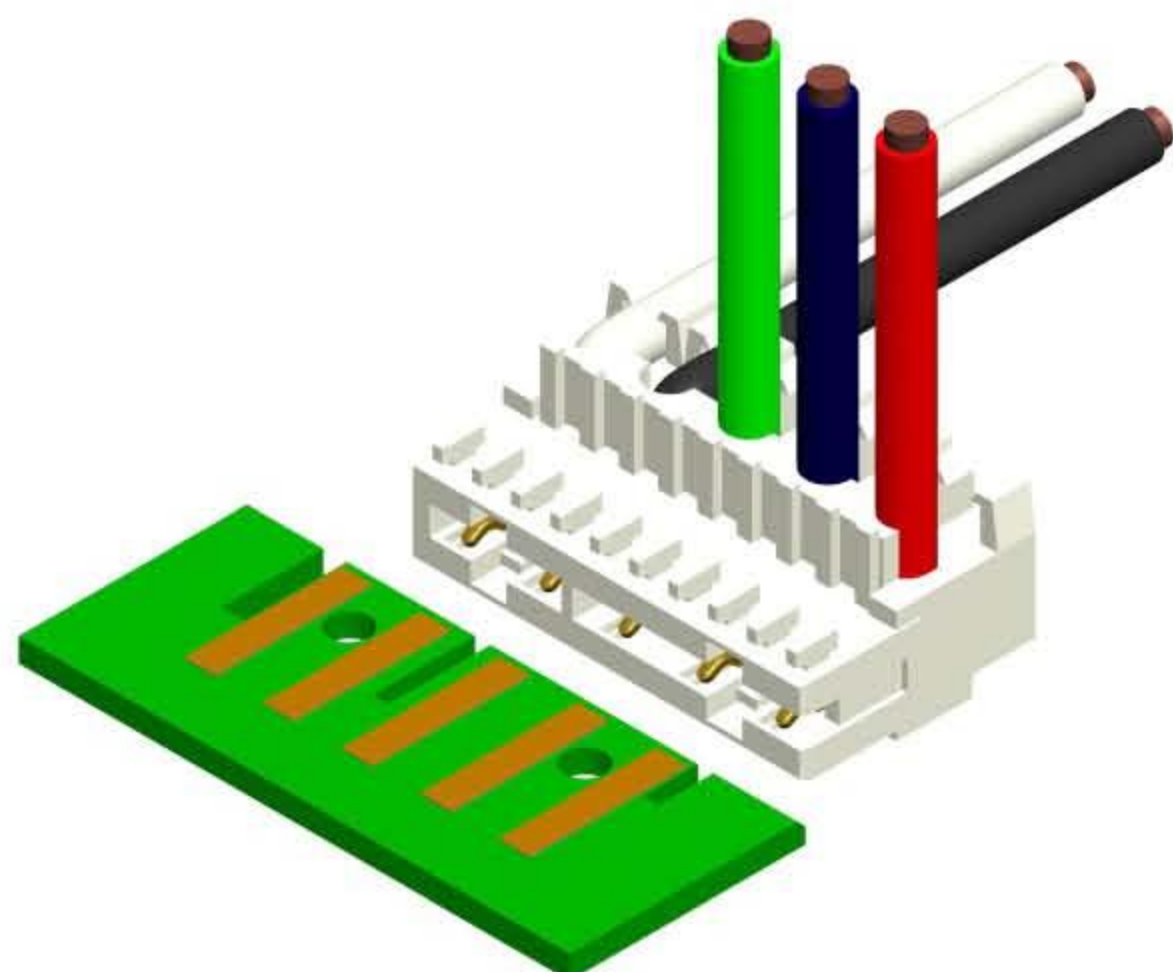

Section: A-A

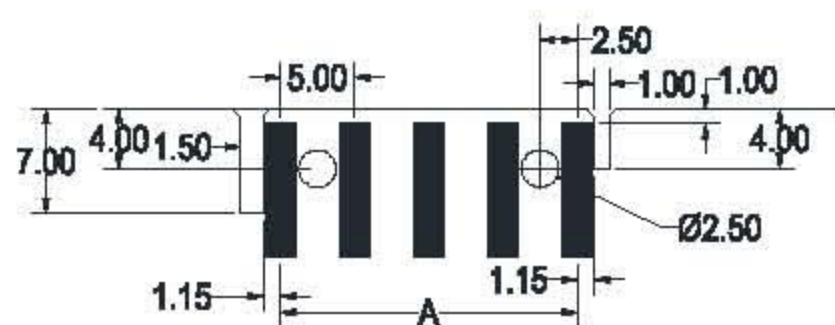
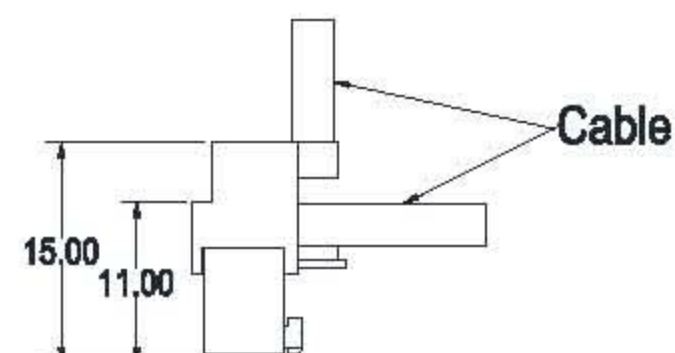

PCB Layout

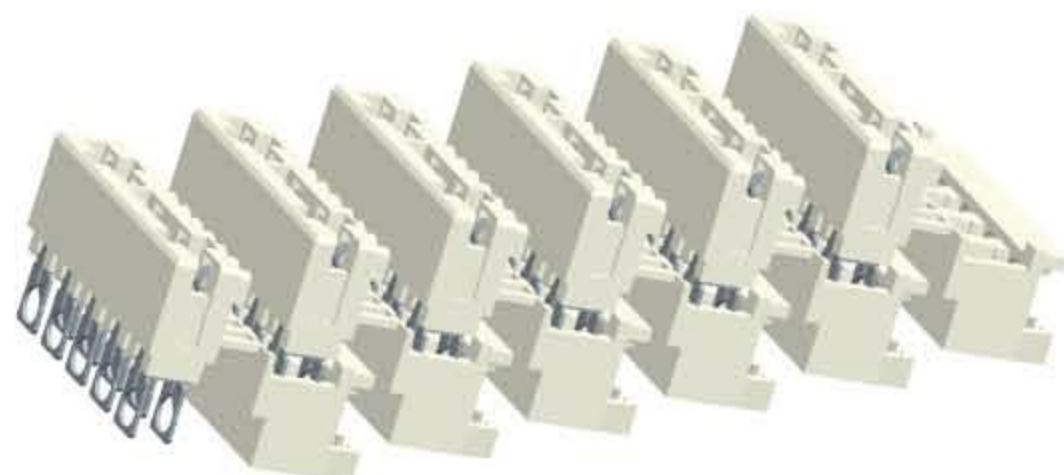
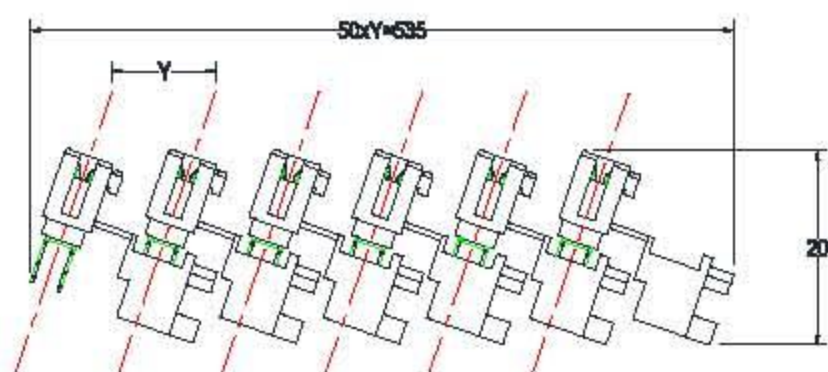

Dimension		
Pos.No.	A	B
2	5	10
3	10	15
4	15	20
5	20	25
6	25	30
7	30	35
8	35	40
9	40	45
10	45	50

M7273 Part Number Definition

M7273-X-X X-X-X-X

